

Hypertherm®

powermax1250™ G3 SERIES™

T80 hand torch consumables



Shielded consumables

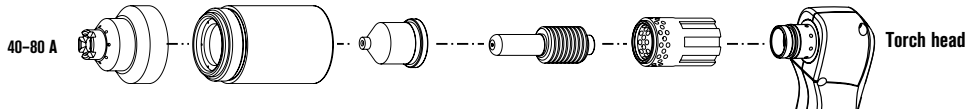

	Shield	Retaining cap	Nozzle	Electrode	Swirl ring
40 A	120929*	120928	120932*	120926*	120925
60 A	120929*	120928	120931*	120926*	120925
80 A	120929*	120928	120927*	120926*	120925

Unshielded** consumables

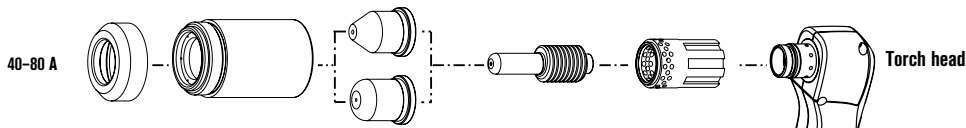

	Deflector	Retaining cap	Nozzle	Electrode	Swirl ring
40 A	120979	120928	220006	120926*	120925
60 A	120979	120928	220007	120926*	120925
80 A	120979	120928	120980	120926*	120925

Gouging consumables

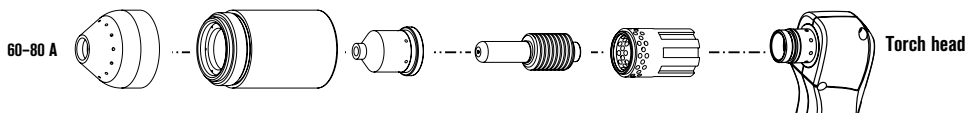

	Shield	Retaining cap	Nozzle	Electrode	Swirl ring
60-80 A	120977	120928	220059	120926*	120925

FineCut consumables

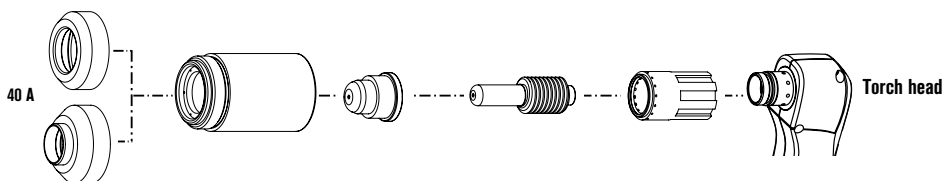

	Deflector	Retaining cap	Nozzle	Electrode	Swirl ring
40 A	120979	120928	220329	120926*	220327
40 A CE***	220325	120928	220329	120926*	220327

**In countries following CE standards, unshielded consumables may only be used in mechanized torch applications.

***CE shield for use in countries requiring CE, CCC, GOST marks.

For improved performance retrofit with a Duramax HRT retrofit torch (see page 85).

New CopperPlus longer life electrode available for Duramax torches. Please refer to the back cover of the catalog for additional information. CopperPlus part number 220777.

Hypertherm®

powermax1250® G3 SERIES™

T80M machine torch consumables



Shielded consumables

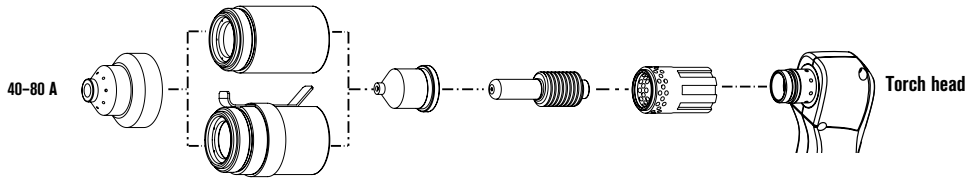

	Shield	Retaining cap	Nozzle	Electrode	Swirl ring
40 A	120930*	120928	120932*	120926*	120925
60 A	120930*	120928	120931*	120926*	120925
80 A	120930*	120928	120927*	120926*	120925
Ohmic		220061			

Unshielded consumables

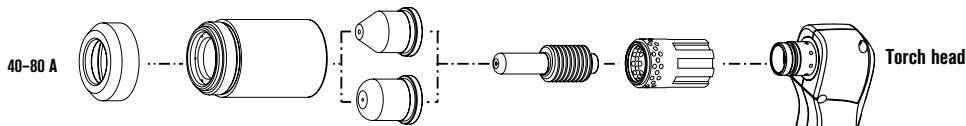

	Deflector	Retaining cap	Nozzle	Electrode	Swirl ring
40 A	120979	120928	220006	120926*	120925
60 A	120979	120928	220007	120926*	120925
80 A	120979	120928	120980	120926*	120925

Gouging consumables

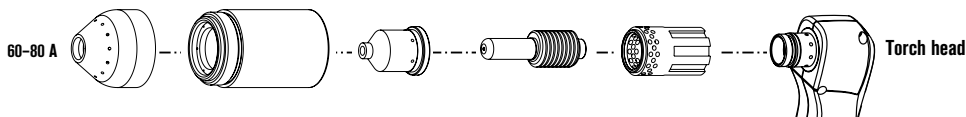

	Shield	Retaining cap	Nozzle	Electrode	Swirl ring
60-80 A	120977	120928	220059	120926*	120925

FineCut consumables

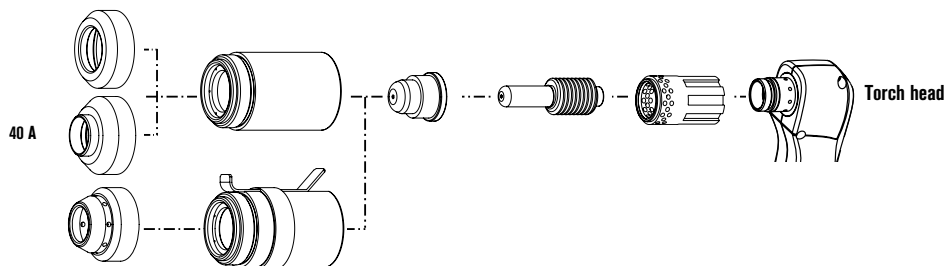

	Shield / Deflector	Retaining cap	Nozzle	Electrode	Swirl ring
40 A	120979	120928	220329	120926*	120925
40 A CE	220325	120928	220329	120926*	120925
Ohmic	220404	220061			

For improved performance retrofit with a Duramax MRT retrofit torch (see page 87).

New CopperPlus longer life electrode available for Duramax torches. Please refer to the back cover of the catalog for additional information. CopperPlus part number 220777.